

Children and Families Update on Estate

Consultative Committee with Parents

14 May 2015

Billy MacIntyre
Head of Resources
Children and Families

Rising Primary School Rolls

- Based on latest 2012 NRS population projections the primary estate roll is expected to increase by 13.2% to 31,700 by 2020 and to an estimated 35,400 by 2030
- The 2012 NRS projections now show births increasing each year to a peak of 6,000 in 2022 and being sustained at around that level thereafter
- The overall city wide trend hides significant variations in different parts of the city
- Committed to providing places in catchment schools and funding of £19.9m has been assigned
- Accommodation pressures in specific schools
- Opportunities for out of catchment placement requests limited

School Community Engagement

- Analysis of contributing factors for each school to predict potential future additional accommodation requirements
- Year of potential accommodation problems identified
- In depth consultation undertaken with each school and parent council to agree solution
- Possible solutions include catchment reviews; internal reconfiguration and improvement and new build
- Continued engagement with school and parents throughout design and delivery of preferred solution

Rising Primary Rolls 2013

- New build delivered at Granton, Wardie and Trinity Primary Schools
- Designed in consultation with schools and Parent Councils
- Design and construction through Hub South East Scotland Ltd
- Planning permission secured for further accommodation if required
- Excellent feedback
- Lessons learned for 2014



Rising Primary Rolls 2014

- Four new build extensions delivered at Broughton, Craigour Park, St David's and Victoria Primary Schools
- Internal improvements undertaken at Stockbridge, Flora Stevenson, Fox Covert and Gylemuir Primary Schools
- Improved consultation with schools and Parent Councils
- Refinement and further development of building designs through Hub South East Scotland Ltd and Scott Brownrigg architects
- Very positively received



Internal Images



Rising Primary Rolls 2015

- Seven new build extensions being delivered at Clermiston, Flora Stevenson, Gilmerton, James Gillespie's, Pentland, Ratho and Wardie Primary Schools
- Internal improvements at Bruntsfield and Liberton Primary Schools
- Creation of temporary P1 and P2 annexe of South Morningside Primary School at the former Deanbank Resource Centre
- Refinement and further development of building designs through Hub South East Scotland Ltd and Scott Brownrigg architects
- Achieving best value for Council – improved buildings at lower cost and only delivered when absolutely certain they are required

Clermiston Primary School



Flora Stevenson Primary School



Gilmerton Primary School



James Gillespie's Primary School



Pentland Primary School



Ratho Primary School



Wardie Primary School



Rising Rolls 2016 & beyond

- Detailed school roll projections updated and reported to Committee in December 2014 and March 2015
- Eight primary schools identified as potentially under pressure for August 2016 – Balgreen, East Craigs, Ferryhill, Fox Covert, Granton, Roseburn, St Mary's RC (Leith) and Towerbank
- New Scottish Government guidance on determining primary school capacity applied
- For Towerbank Committee approved that catchment review represented the only reasonable option due to already very restricted site
- Following a period of informal consultation, the statutory consultation on four options for catchment change at Towerbank commenced on 8 May 2015

Rising Rolls 2016 & beyond

- Consultation undertaken with other schools to review all options. On 19 May Committee will consider proposed solutions for the seven schools for August 2016
- Stand alone extensions proposed for Balgreen, East Craigs, Fox Covert and St Mary's (Leith) RC Primary Schools
- Designs will be progressed and planning applications submitted later this year. Exception is East Craigs for which approved design already in place.
- Internal adaptations proposed for Ferryhill, Granton and Roseburn Primary Schools
- Decision to progress by no later than January 2016
- Annual programme of re-forecasting, identifying pressures, consultation, design & delivery will continue

Secondary School Rising Rolls

- Rising rolls in the primary sector will work through to the secondary sector
- The city wide secondary school roll is projected to rise from 2017 to an estimated 20,700 by 2020 and then to an estimated 24,600 by 2030
- Whilst good news educationally increasing stay-on rates create accommodation pressures. Between 2008 and 2014 the average stay-on rate between S4/S5 increased from 80% to 90% whilst that between S5/S6 increased from 64% to 76%
- In the 2014/15 the S1 intake was 3,157, the lowest since 1980; the S1 intake in August 2015 is expected to be 3,321 with 2015/16 expected to be a turning point for S1 intakes
- It is anticipated that this will create capacity issues at many secondary schools

Secondary School Rising Rolls

- Have therefore begun process to identify possible options to create additional capacity, ideally without having to provide additional accommodation
- Assessment carried out by a former secondary school Head Teacher and involved consultation with all secondary Head Teachers.
- The outcome of the analysis is that three areas merit, and require, further consideration:
 - Review capacity methodology to determine a more flexible system where S1 intake levels are more closely related to stay on rates in the senior school.
 - Investigate opportunities where groups of schools could increase collaboration in relation to delivery of the senior school curriculum.
 - Investigate opportunities for changing the structure of the school day.

Early Years

- The Children and Young People (Scotland) Act 2014 set out the requirement to expand free nursery provision from 475 hours to 600 hours a year for all three and four year olds and for certain two year olds
- The Scottish Government provided additional capital funding of £9.892m to the Council to respond to the necessity to deliver additional capacity across the estate as a result of these new requirements
- Committee previously approved funding to deliver replacement and/or expanded early years facilities at Longstone Primary School; Granton Early Years Centre, Davidson's Mains Primary School, Corstorphine Primary School, the new St John's RC Primary School and Fox Covert Primary Schools

Early Years

- On 19 May 2015 Committee is being asked to approve funding to improve, replace or expand early years facilities at Leith Primary School, Tynecastle Nursery, Blackhall Nursery and Ferryhill Primary School
- Council previously approved a replacement nursery at Duddingston Primary School and completely new nurseries at Fox Covert Primary Schools and Wardie Primary School
- Construction of these is underway and they are due to open in August 2015
- Continued engagement with schools throughout design and delivery of preferred solution

New Duddingston Nursery



New Fox Covert Nursery



New Wardie Nursery



Primary School Estate

- £5.3m phased extension to Kirkliston Primary School; contractor appointed and works on Phase 1 now underway – new gym hall, dining and up to eight classrooms allowing the removal of temporary units
- New gym hall being delivered at Blackhall Primary School
- Funding approved for new St John's RC Primary School; location of site for new school approved by Council to be part of site of existing Portobello High School
- Currently finalising affordability cap for St John's with proposed contractor
- Subject to Committee approval on 19 May 2015, new hall to be provided at Buckstone Primary School funded by developer contributions

Primary School Estate

- Significant additional capital funding secured from Scottish Government to provide necessary additional accommodation at primary schools affected by the change to the entitlement for free school meals to all P1-P3 pupils from January 2015
- Significant additional capacity for school meals required and will be delivered at four schools - new gym halls will be delivered at Cramond and East Craigs Primary Schools with extensions being delivered at Sciennes and Towerbank Primary Schools
- A feasibility study is being progressed to identify options for permanent replacement gym, early years and community accommodation to be provided at Leith Primary School following the closure of Duncan Place

Primary School Estate

- A permanent long term solution is required to the accommodation pressures in south Edinburgh (Bruntsfield, James Gillespie's and South Morningside Primary Schools)
- On 19 May 2015 Committee will consider a proposal to undertake a statutory consultation later this year on a number of options to address this requirement
- One of the options is to establish an entirely new primary school on the combined site of the existing South Morningside Deanbank temporary annexe and the adjacent Oaklands Care Home on Canaan Lane. This would incorporate sections of the Bruntsfield, James Gillespie's and South Morningside catchment areas.

Extension to Kirkliston Primary



Blackhall Primary School Gym



New St John's RC Primary School



EXISTING SCHOOL

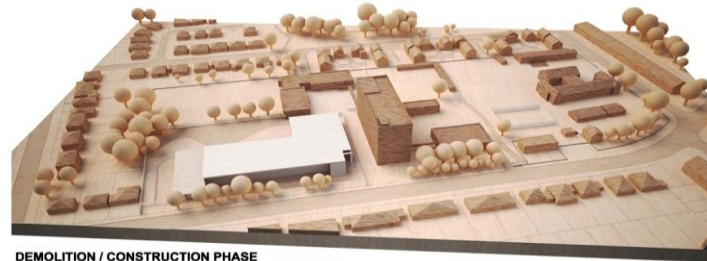

DEMOLITION / CONSTRUCTION PHASE

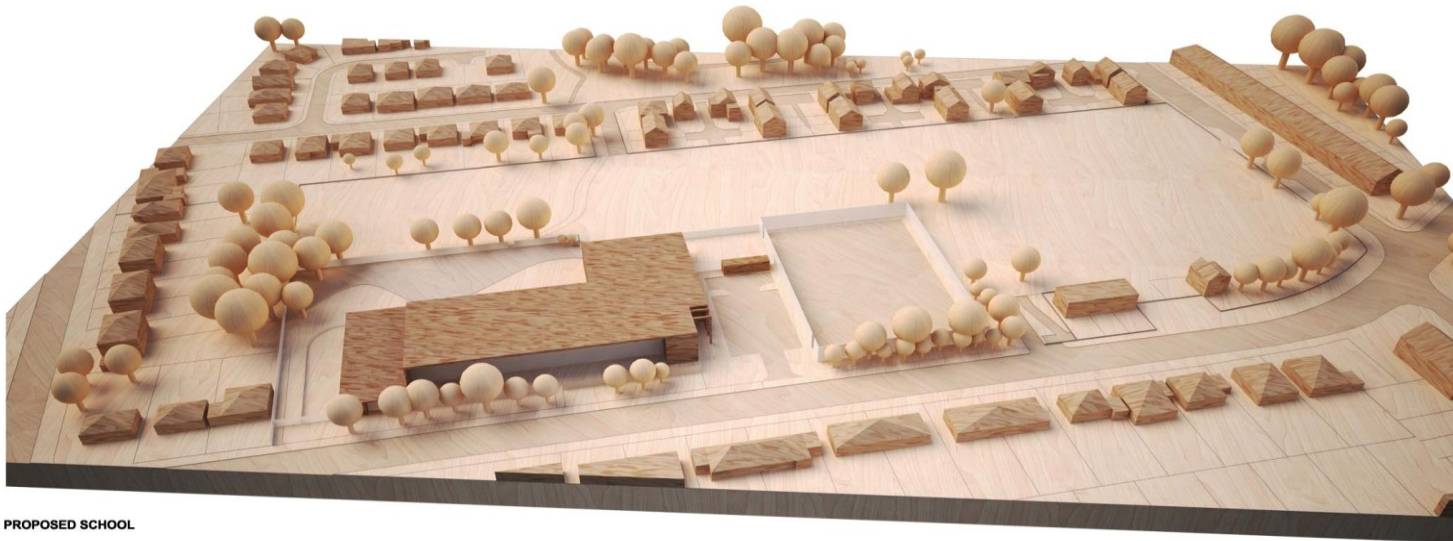

PROPOSED SCHOOL

St Johns Primary School
3410.109 Images



♦ EDINBURGH ♦
YOUR COUNCIL - YOUR FUTURE

Special Schools and Residential Estate

- Replacement for Greendykes Young People's Centre being delivered in Dumbryden; planning consent secured and currently out to tender
- Business case to be taken to Committee later this year regarding the proposed replacement of Oxfangs Young People's Centre
- Funding approved for new St Crispin's Special School; yet to be progressed as funding is later in the five year capital investment programme. Site options currently being considered

New Young People's Centre



Secondary School Estate

- New James Gillespie's High School - construction of first phase teaching block now completed and opened April 2015; final phase to deliver the sports and performance buildings is now underway
- New Boroughmuir High School – construction work well underway
- New Portobello High School – Private Bill approved and construction work well underway
- Liberton High School – demolition of old gym hall and provision of replacement PE facilities approved; planning permission secured and about to be tendered
- New secondary school in Craigmillar – site for new school identified in the new town centre masterplan

Secondary School Estate

- Proposal submitted to the Scottish Government regarding the replacement of Queensferry High School on its existing site
- Council funding required for the project is already approved and currently await decision from the Scottish Government

New James Gillespie's High School



New Boroughmuir High School



New Portobello High School



Liberton High School Sports Hall



Proposed Local Development Plan

Local Authorities must:

- Prepare Local Development Plans (LDP) every five years
- Prepare Action Programmes and update them at least every two years
- Maintain an effective five year housing land supply at all times

LDP Housing Land Supply Target:

- Land required for 32,460 housing units
- Based on Strategic Development Plan requirements
- Approximately 24,000 houses from existing sources
- Approximately 8,500 houses/flats from new LDP sites

Plan Led Approach to Infrastructure

- Education needs are assessed cumulatively with requirements set out in Educational Infrastructure Appraisal
- Informs actions in LDP Action Programme
- Major actions have 'contribution zones'
- Any new development in a contribution zone expected to pay its share of total costs in that zone
- Council responsible for delivery of these actions. Delivery is overseen by corporate Action Group; Action Programme regularly reviewed and updated
- If development value insufficient, or action needed before phased payments all received – Council may need to fund gap – Council risk if development stalls

Education Infrastructure Appraisal

- Appraisal of impact on education infrastructure produced by Children and Families as part of LDP process and published on Council website
- New houses/flats in the LDP estimated to produce an additional 3,500 primary/secondary pupils although likely to be overlap with the projected rise in the population and overall school rolls
- Calculated expected pupil generation from new housing based on defined ratios for flats and houses
- Assessed capacity of existing education infrastructure in the area to absorb additional pupils and identified actions required to address any gaps in school capacity

Education Infrastructure Appraisal

- Many actions show a number of options; further feasibility work is required in many areas and capital funding has now been identified to progress these
- Significant potential additional investment identified to be funded by developers
- Five new primary schools, extra accommodation at existing primary schools , increased capacity in secondary schools and catchment reviews

Queensferry

Primary School Requirements	Indicative Cost	Catchment Change Requirements
New 14 class primary school at Builyeon Road	£9.603m	Echline and Queensferry Primary Schools.
2 class extension to St Margaret's RC PS	£573,000	n/a

Secondary School Requirements	Indicative Cost	Catchment Change Requirements
Additional capacity – 232 pupils (Queensferry High School)	£5.8m	n/a
Additional capacity – 17 pupils (St Augustine's RC High School)	£425,000	n/a

West Edinburgh

Primary School Requirements	Indicative Cost	Catchment Change Requirements
New 21 class primary school (Maybury)	£12.72m	Cramond and Corstorphine
4 class extension (including 1 GP space) to Gylemuir PS	£831,000	Gylemuir extended
2 class extension to Fox Covert RC	£573,000	n/a
3 class extension to Hillwood PS	£679,000	Hillwood extended

Secondary School Requirements	Indicative Cost	Catchment Change Requirements
Additional capacity - 441 ND pupils (Royal High, Craigmount or Forrester) Feasibility study	£11.025m	tbc in feasibility study
Additional capacity - 77 RC pupils (St Augustine's RC High School)	£1.925m	n/a

South West Edinburgh

Primary School Requirements	Indicative Cost	Catchment Change Requirements
5 class extension at Currie PS	£966,000	n/a

South East 1 – Gilmerton/Liberton

ND Primary School Requirements – Option 1	Indicative Cost	Catchment Change Requirements
New 9 class Primary School - Broomhills	£7.551m	Gracemount and Gilmerton
New 7 class Primary School - Gilmerton	£6.332m	Gilmerton

ND Primary School Requirements – Option 2	Indicative Cost	Catchment Change Requirements
Extend Gilmerton PS to 4 stream (29 classes)	feasibility study	Gracemount, Gilmerton, Liberton and Craighour
Extend Gracemount PS to 4 stream (29 classes)	feasibility study	
Extend Liberton and Craighour Park	feasibility study	

RC Primary School Requirements – Options 1&2	Indicative Cost	Catchment Change Requirements
1 class extension to St John Vianney RC PS	£300,000	n/a
3 class extension to St Catherine's RC PS	£679,000	n/a

South East 1 – Gilmerton/Liberton

Secondary School Requirements - ND	Indicative Cost	Catchment Change Requirements
Additional capacity - 260 ND pupils at Liberton High School and/or Gracemount High School Feasibility Study	£6.5m	tbc through feasibility study

Secondary School Requirements – RC	Indicative Cost	Catchment Change Requirements
Holy Rood RC High School - priority to baptised RC pupils	None	n/a

South East 2 – Castlebrae

Primary School Requirements – Option 1	Indicative Cost	Catchment Change Requirements
New 14 class Primary School – Brunstane	£9.603m	Newcraighall Primary School
St Johns RC Primary to give priority to baptised RC pupils	n/a	n/a

Primary School Requirements – Option 2	Indicative Cost	Catchment Change Requirements
As above but include 2 class extension to Newcraighall Primary	£573,000	n/a

Secondary School Requirements	Indicative Cost	Catchment Change Requirements
Additional capacity - 255 pupils (Castlebrae High School)	£6.375m	n/a
Holy Rood RC High School to give priority to baptised RC pupils.	n/a	n/a

Asset Management Plan

- An updated Children and Families Asset Management Plan (including a detailed action plan) was approved by Committee on 9 December 2014
- The first six monthly latest update report to Committee on 19 May 2015 provides a summary of the current status of all Children and Families asset related projects and initiatives through an update of the action plan
- Detail also provided on two key areas of work identified in the action plan as requiring to be progressed during 2015:
 - the review of primary school capacities based on the new Scottish Government guidance;
 - the issue of rising rolls in the secondary sector

Wave 4

- Since 2000 the Council has undertaken a significant and sustained level of investment in its school estate
- With funding having been identified to deliver all five schools in the Wave 3 programme, and most of the projects well underway, it is now appropriate to consider a fourth wave of investment – a 'Wave 4' school investment programme
- On 25 September 2014 Council received an update on the existing priorities within the Wave 4 programme (addressing the long term accommodation pressures in south Edinburgh and delivering a new secondary school in Craigmillar) and approved the proposed approach to determining the remaining scope of that programme

Wave 4

- Six secondary schools and eight primary schools were identified to be considered for inclusion in the scope of Wave 4
- The assessment of all schools to determine those which should be short-listed for further detailed consideration is currently ongoing.